



MODULAR OUTDOOR KITCHEN

BBQ1100300

DOUBLE DRAWER SET incl. screw set

ASSEMBLY INSTRUCTIONS

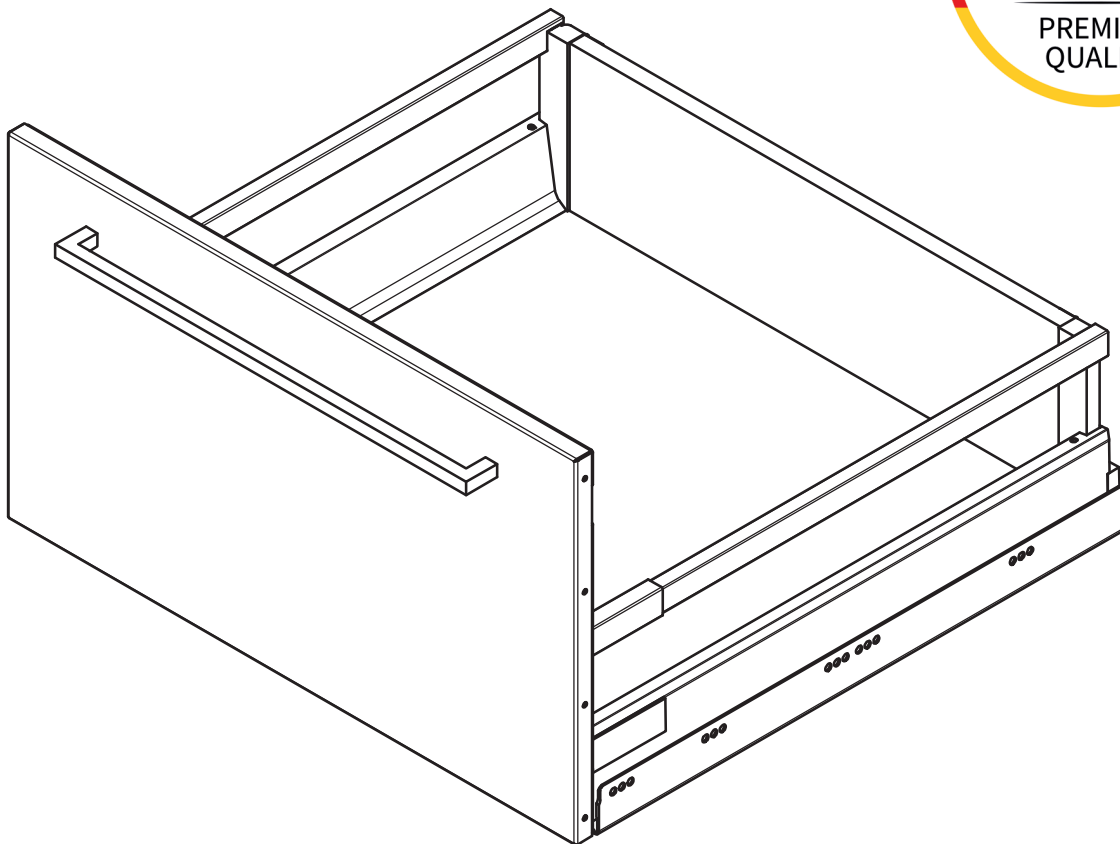

→ Video guide

REV 1.0
03/2023



DE

TABLE OF CONTENTS

EN

KEY POINTS FOR ASSEMBLY 3

FOR YOUR SAFETY 3

CARE AND MAINTENANCE 3

FR

IMPORTANT FOR THE FOUNDATION 3

DESCRIPTION OF SYMBOLS 3

IT

SCOPE OF DELIVERY 4

ASSEMBLY 5

ES

CZ

KEY POINTS FOR ASSEMBLY

These assembly instructions show the assembly of the outdoor barbecue kitchen. Read these assembly instructions carefully before commissioning! Failure to observe the risks, warnings and safety precautions set out in these assembly instructions may result in injuries or property damage.

Observe a working temperature of +5 °C to +35 °C for assembly.

FOR YOUR SAFETY

	DANGER! Danger of death and physical injury owing to improper use. <ul style="list-style-type: none"> Observe the Weber barbecue manual!
---	--

	ATTENTION! Risk of cutting on sharp edges. <ul style="list-style-type: none"> Install a keder strip on sharp edges
---	--

	ATTENTION! Damage to the base module with drawers owing to tipping. <ul style="list-style-type: none"> The base module with drawers may only be used in combination with a barbecue attachment or other base modules with doors or corner element. Anchoring to the wall using a wall mounting element is also permissible.
---	---

	ATTENTION! Damage to the modules <ul style="list-style-type: none"> First assemble all base modules and connect all base modules together before installing drawers, insert compartments, doors, etc.
---	---

	ATTENTION! Damage to the outdoor barbecue kitchen owing to high temperatures. <ul style="list-style-type: none"> The wall mounting element is a technical component which is not suitable for attachment to heat-sensitive materials. Do not place the wall mounting element on insulated or plastered walls. Have the façade or structure approved for attachment of the outdoor barbecue kitchen in advance by the manufacturer. Appropriate thermal separation between the outdoor barbecue kitchen and the façade or structure must be ensured on site (excluded from the product liability!). A temperature of up to 180 °C should be anticipated for wall mounting elements. Please note that the radiant heat from barbecues can still be up to 150 degrees 25 cm away.
---	---

CARE AND MAINTENANCE

	ATTENTION! Damage to the outdoor barbecue kitchen owing to storm winds. <ul style="list-style-type: none"> Position the outdoor barbecue kitchen in an area which is sheltered from the wind.
---	---





- Do not store aggressive chemicals such as chlorine or de-icing salt in the outdoor barbecue kitchen.
- Remove sunscreen and other creams with water and soap.
- Do not use abrasive cleaning agents.
- The surfaces of the outdoor kitchen may become scratched. Protect the surfaces with liner and/or non-slip mats.

IMPORTANT FOR THE FOUNDATION

Prevent rising soil moisture and condensation by means of a thick plastic sheet under the foundation. Pay attention to rainwater in the foundation design.

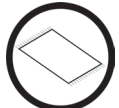
Place the outdoor barbecue kitchen on a paved area.

DESCRIPTION OF SYMBOLS

	USE WORK GLOVES DURING ASSEMBLY!
	USE A SUITABLE UNDERLAY TO PREVENT SCRATCHES!
	YOU WILL NEED A HELPER FOR THIS ASSEMBLY STEP.
	TOOLS REQUIRED FOR THIS ASSEMBLY STEP.
	NOTE/INFORMATION
	SPIRIT LEVEL SYMBOL Align the part in question using the spirit level.

SCOPE OF DELIVERY

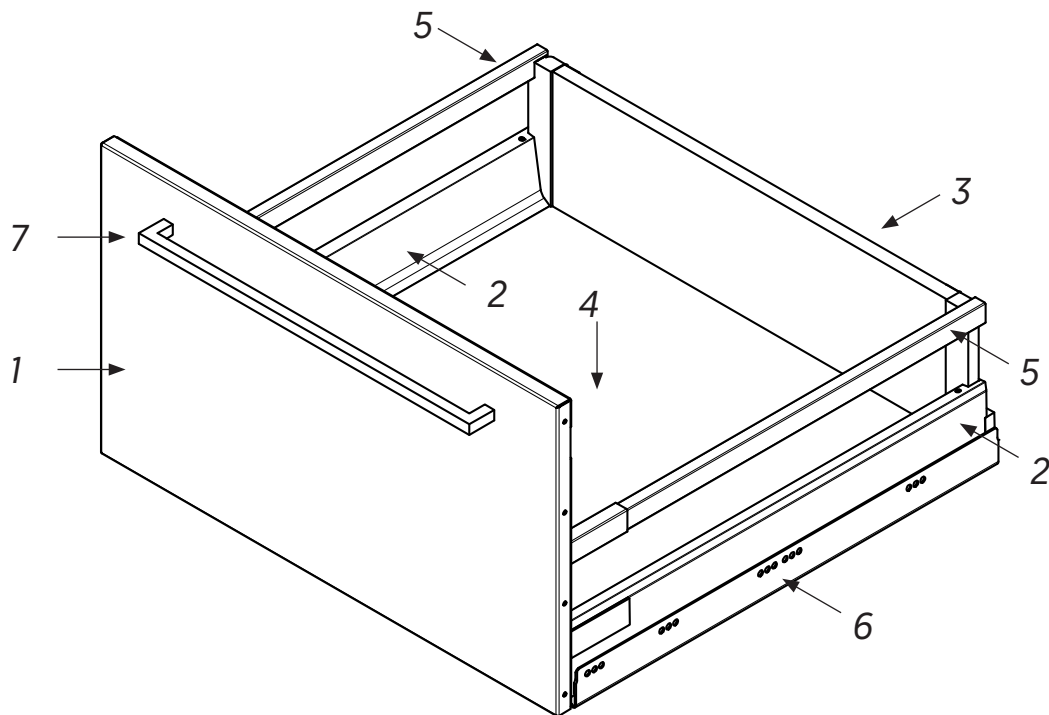

1	BBQ2000109 drawer front
2	BBQ2000175 Tandembox left profile & BBQ2000176 Tandembox right profile
3	BBQ2000185 Tandembox steel back panel
4	BBQ2000108 drawer bottom
5	BBQ2000181 Tandembox left lengthwise railing & BBQ2000182 Tandembox right lengthwise railing
6	BBQ2000215 Tandembox left/right cabinet pro- file set, TOB 65 kg, 550 mm
7	BBQ2000110 stainless steel handle – length 420 mm
	BBQ2000237 small parts drawer set
	BBQ1100300a accessory set drawer set

ASSEMBLY

ACCESSORIES – BBQ1100300A:

2 pcs. stainless steel handle, 420 mm
 2 pcs. Tandembox left profile
 2 pcs. Tandembox right profile
 2 pcs. Tandembox left/right cabinet profile set
 2 pcs. Tandembox left lengthwise railing
 2 pcs. Tandembox right lengthwise railing
 2 pcs. Tandembox steel back panel
 1 pc. small parts drawer set BBQ2000237:

small parts drawer set – BBQ2000237:

42 pcs. truss head screws M4x10 DIN 7380-1 A2 Tx 20
 4 pcs. Tandembox front fixing
 4 pcs. truss head screws M3x10 Tx 20
 4 pcs. Tandembox railing front fixing
 4 pcs. Tandembox cover cap



Tx20



SW 2.5



SW 3

- 1** Attach the front fixing to the front panel with 4 truss head screws M4x10.

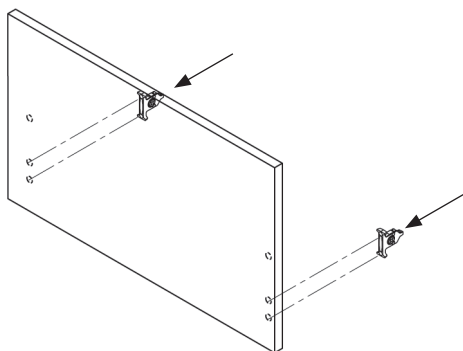

- 2** Attach the railing fixing with 2 truss head screws M3x10.

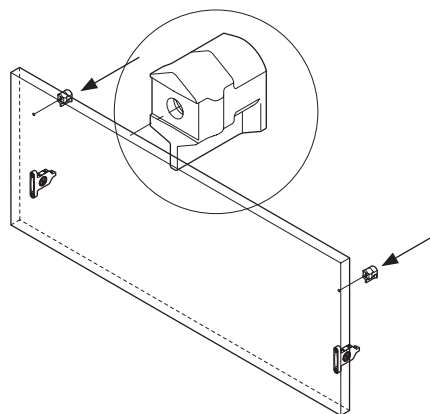

- 3** Connect the left and right profiles to the steel back panel.

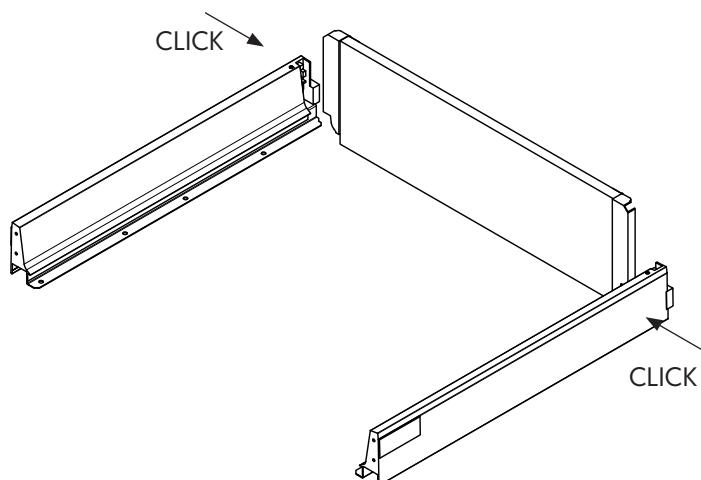

- 4** Attach the base plate to the two profiles with 8 truss head screws M4x10.

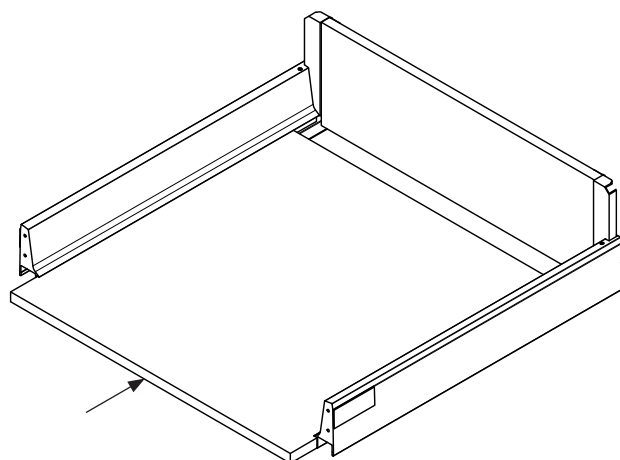

DE

EN

FR

IT

ES

CZ

- 5** Connect the front panel to the two profiles.

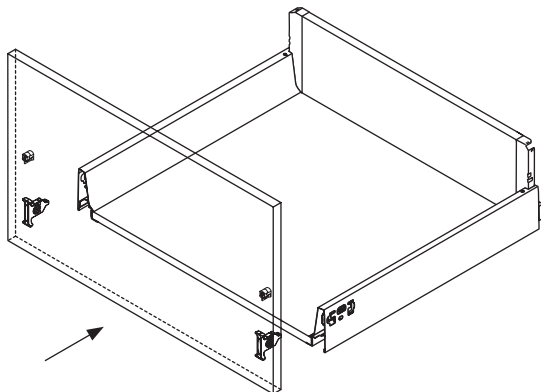

- 6** Connect the steel back panel to the front panel using the lengthwise railings (left + right).

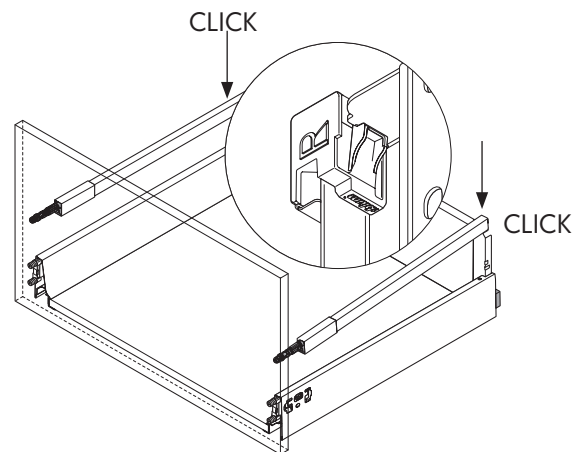

7

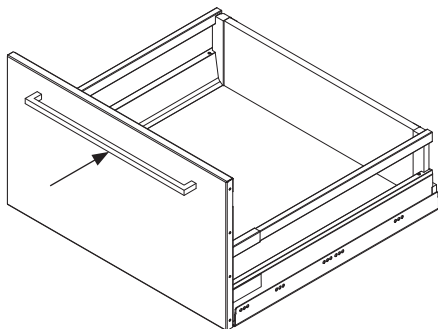

- 8** Attach the left + right cabinet profiles to the base module.

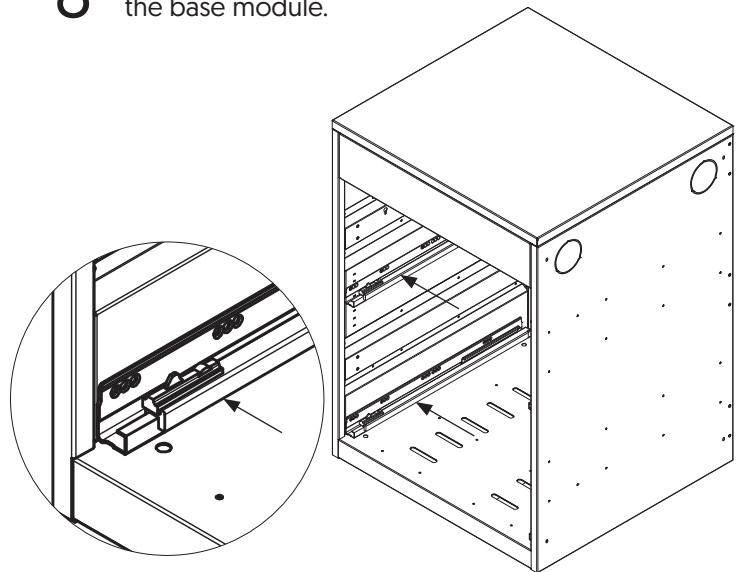

Attach the stainless steel handle with the enclosed screws.

- 9** Slide the drawer onto the cabinet profiles in the base module.

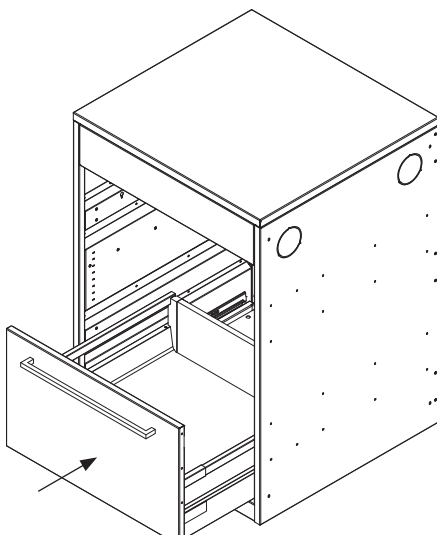

- 10** Adjust the front panel in height and at the sides in order to get an even gap.

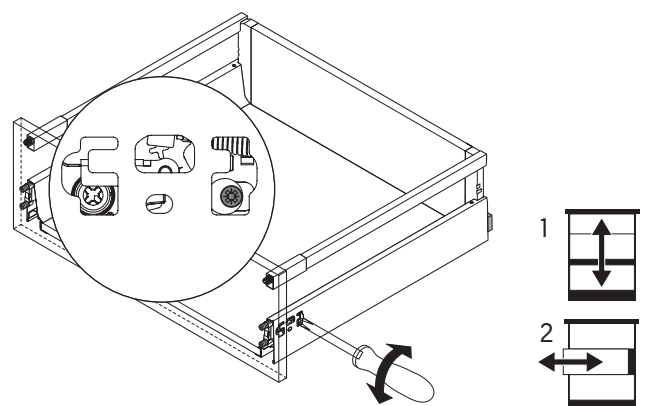

- 11** Adjust the angle of the front panel on the lengthwise railing. Then slide the cover cap forward.

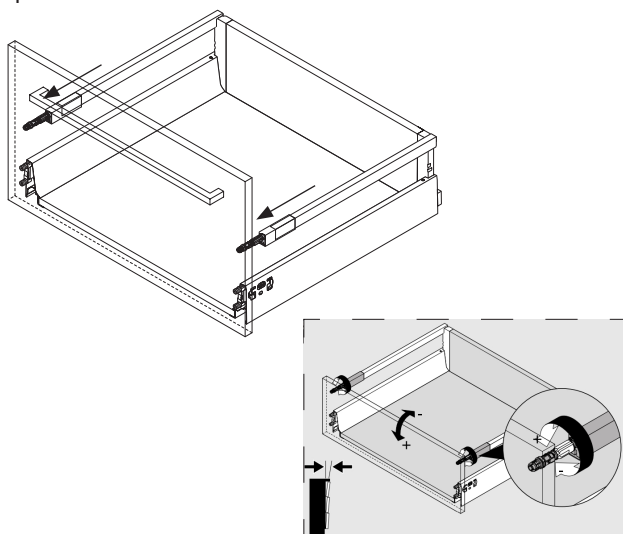

- 12** Install the cover caps.

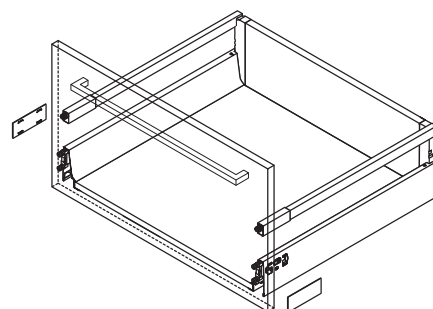

- 13** DONE

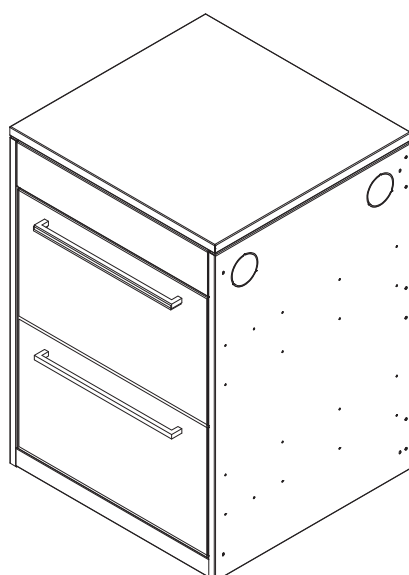

ATTENTION! Tipping over of the base module with drawers may result in property damage.

- The base module with drawers may only be used in combination with a barbecue attachment or other base modules with doors or corner element. Anchoring to the wall using a wall mounting element is also permissible.

DE

EN

FR

IT

ES

CZ



THE MODULAR OUTDOOR KITCHEN
PERFECT FOR EVERY TERRACE.
CREATED IN AUSTRIA - MADE IN GERMANY

OFFICE@BBQ-KITCHEN.COM
[+43] 7243 23 596



BBQ KITCHEN GMBH
MERKURSTRASSE 11
4614 MARCHTRENK | AUSTRIA

WWW.BBQ-KITCHEN.COM